

# AROMA<sup>®</sup>

## *4-Slice Toaster*



## **Instruction Manual**

*Model ATS-274W*

Congratulations! Your **AROMA** 4-slice toaster is sure to be an attractive and helpful addition to your home.

Please read the following instructions carefully before your first use.



Published By:

Aroma Housewares Co.  
6469 Flanders Drive  
San Diego, CA 92121  
U.S.A.  
1-800-276-6286  
[www.aromaco.com](http://www.aromaco.com)

© 2006 Aroma Housewares Company All rights reserved.

# IMPORTANT SAFEGUARDS

*Basic safety precautions should always be followed when using electrical appliances, including the following:*

1. Read all instructions before using the appliance.
2. Do not touch hot surfaces. Use handles or knobs. Metal surfaces become extremely hot.
3. To prevent against electrical hazards, do not immerse cord, plug or toaster in water or other liquid. See instructions for cleaning.
4. Close supervision is necessary when any appliance is used by or near children.
5. Always unplug appliance from outlet when not in use and before cleaning. Allow to cool before cleaning and handling.
6. Do not operate any appliance with a damaged cord or plug. Do not use after appliance malfunctions, is dropped or damaged in any manner. Return the appliance to an authorized service facility for examination, repair or electrical/mechanical adjustment.
7. The use of accessory attachments not approved by the appliance manufacturer is not recommended and may cause injuries.
8. Do not use outdoors.
9. Do not let cord hang over edge of table or counter or touch hot surfaces.
10. Do not place toaster on or near a hot gas or electric burner or in a heated oven.
11. To disconnect, grasp plug at base and remove from outlet. Never unplug by pulling on the cord.
12. Do not use toaster for other than intended use.
13. Oversized foods, foil packages or utensils must not be inserted in the toaster as they present a risk of fire or electric shock.
14. A fire may occur if toaster is covered by or touching flammable material including curtains, draperies and walls during operation.
15. Do not attempt to dislodge food when the toaster is plugged into electrical outlet.
16. To avoid possibility of fire, do not leave toaster unattended during use.
17. Clean out accumulated crumbs frequently to avoid risk of fire or toaster malfunction. Do not use foods that will drip coatings or fillings when heated. Such accumulations inside the toaster create unsanitary conditions and the possibility of fire or toaster malfunction. Unplug when not in use and before cleaning.

## SAVE THESE INSTRUCTIONS

# SHORT CORD INSTRUCTIONS

1. A short power-supply cord is provided to reduce the risk of becoming entangled in or tripping over a longer cord.
2. Longer extension cords are available and may be used if care is exercised.
3. If a longer extension cord is used:
  - a. The marked electrical rating of the extension cord should be at least as great as the electrical rating of the appliance.
  - b. The longer cord should be arranged so that it will not drape over the counter top or tabletop where it can be pulled by children or tripped over unintentionally.

## POLARIZED PLUG

This appliance has a **polarized plug** (one blade is wider than the other); follow the instructions below:

To reduce the risk of electric shock, this plug is intended to fit into a polarized outlet only one way. If plug does not fit fully into the outlet, reverse the plug. If it still does not fit, contact a qualified electrician. Do not attempt to modify the plug in any way.



**This appliance is for household use only.**

# PARTS IDENTIFICATION

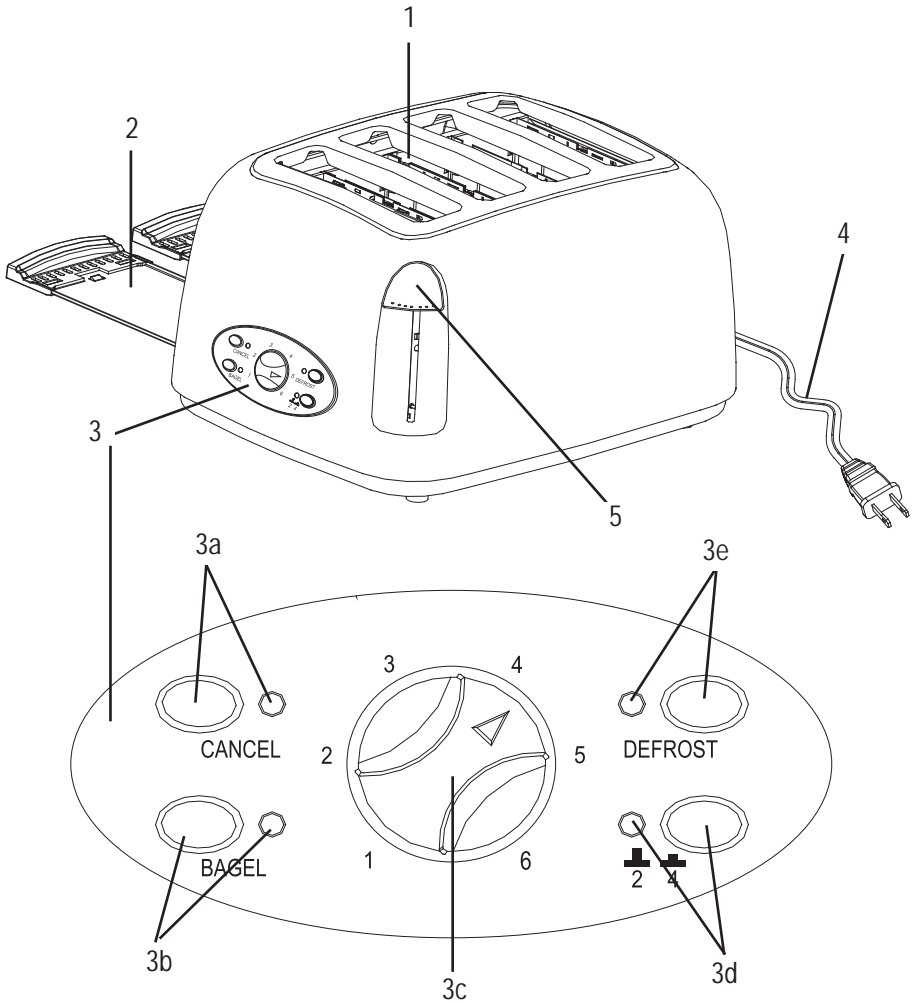

- |  |                |
|--|----------------|
| 1. Self Centering Toast Wells                | 4. Power Cord  |
| 2. Removable Crumb Trays                     | 5. Toast Lever |
| 3. Control Panel                             |                |
| a. Cancel Button and Indicator Light         |                |
| b. Bagel Button and Indicator Light          |                |
| c. Browning Control Knob                     |                |
| d. 2 or 4 Slice Selector and Indicator Light |                |
| e. Defrost Button and Indicator Light        |                |

# HOW TO USE

1. Before first use, remove all packaging material and make sure that your toaster is received in good condition.
2. For first time use, run toaster empty through a full cycle to allow the new elements to preheat and burn off any residue that may have accumulated during assembly.
3. Make sure the crumb tray is in place and the toast lever is in the UP position.
4. Place toaster on a flat, stable surface away from the edge of counter or tabletop and at least 3 inches away from wall or back of counter.
5. Unwind power cord and plug into a nearby outlet.
6. Make sure the toast lever is in the UP position and insert bread slices into toast wells.
7. Turn the browning control knob to desired position. The higher the number (1-6), the darker the toast.
8. Press the toast lever down until it locks into position.
9. Select 2-slice or 4-slice function according to the number of slices to be toasted.
10. Select defrost or bagel function if needed.
11. When the toasting cycle is complete, the toast will automatically pop up. To terminate the toasting cycle before it has completed, press the Cancel button.
12. After use, unplug the toaster from the electrical outlet.
13. Never wrap cord around outside of toaster. Cord should be stored on the storage cleats under the toaster.

# HOW TO USE

## 2 or 4 Slice Selector

The 2 or 4 Slice button allows you to choose how many slices of toast you would like to prepare at one time. When using the 2-slice function, place your bread slices in the forwardmost toast wells (those closest to the control panel). See Figure 1 below for a diagram.

-When the button is depressed, or IN, the toaster is on 4-slice mode.

-When the button is not depressed, or OUT, the toaster is in 2-slice mode.

## Bagel Function

*Note:* The bagel function is programmed to toast only one side of the sliced bagel.

1. Cut the bagel into two equal halves.
2. Insert the bagel halves into the toast wells **with the cut sides facing each other in adjacent toast wells**. See Figure 1 below for a diagram.
3. Press the toast lever down until it locks into position.
4. Select between 2-slice and 4-slice mode on the control panel.
5. Press the Bagel button.
6. When the toasting cycle is complete the toast will automatically pop up.
7. If you wish to terminate the cycle before it has completed, press the Cancel button.

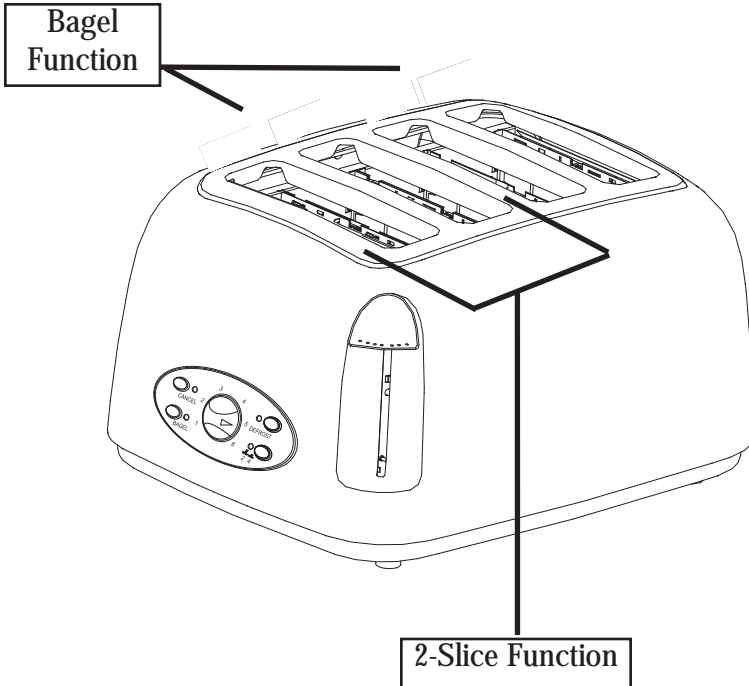

# HOW TO USE

## Defrost Function

1. Insert bread slices into the toasting wells.
2. Turn the browning control knob onto the desired position:
  - Setting 1-2: for refrigerated breads and thinner frozen items such as frozen pancakes.
  - Setting 3-4: for pastries, frozen waffles, thin French toast and refrigerated bagels.
  - Setting 5-6: for thicker frozen items such as bagels, hand cut bread and thick French toast.
3. Press the toast lever down until it locks into position.
4. Select either 2-slice or 4-slice mode on the control panel.
5. Press the Defrost button.
6. When the cycle is complete, the toast will automatically pop up. To terminate the cycle before it has completed, press the Cancel button.

## HELPFUL HINTS

*Toasting is a combination of drying and cooking the bread. Moisture levels differ from one type of bread to the other, which can result in varying toasting times.*

1. For slightly dry bread, use a lower setting (1-3) on the browning control knob.
2. For fresh bread or whole wheat, use a higher setting (4-6) on the browning control knob.
3. Breads with very uneven surfaces, such as English muffins, will require a higher setting (4-6) on the browning control knob.
4. Thickly cut pieces of bread, such as bagels, will take longer to toast since more moisture must be evaporated from the bread before toasting can occur.
5. Extremely thick pieces may require two toasting cycles.
6. When toasting breads containing fruit, remove all loose pieces before placing in the toaster. This will prevent loose items from falling into the toaster or sticking to the guard wire.
7. Before toasting bagels, slice into two equal halves, place them in the toaster with the **cut sides facing each other in adjacent toast wells** (see page 5 for diagram) and select the Bagel function. The bagel function only toasts one side of the bagel slice.
8. When toasting a single slice, use a lower setting (1-3) on the browning control knob.
9. For frozen items, such as pancakes, bagels and waffles, use the Defrost function.
10. Use caution when toasting pastries as filling can become very hot before the surface of the pastry becomes brown.

## HOW TO CLEAN

1. Always unplug unit and allow to cool before cleaning.
2. **Do not use abrasive cleaners.** Simply wipe the exterior with a clean damp cloth and dry thoroughly. If a cleaning solution is used, apply to a clean cloth and not directly onto the toaster.
3. To remove crumbs, slide out the crumb tray and discard crumbs. Wipe clean and replace. Never operate the toaster without the crumb tray in place.
4. To remove bread caught in the toaster, unplug from outlet, turn upside down and shake gently. **Never insert any hard or sharp object into toaster.**

# LIMITED WARRANTY

Aroma Housewares Company warrants this product free from defects in material and workmanship for one year from the provable date of purchase in the continental United States.

Within this warranty period, Aroma Housewares Company will repair or replace, at its option, defective parts at no charge, provided the product is returned, freight prepaid with proof of purchase and U.S. \$9.00 for shipping and handling charges payable to Aroma Housewares Company. Before returning an item, please call the toll free number below for a return authorization number. Allow 2-4 weeks for return shipping.

This warranty does not cover improper installation, misuse, abuse or neglect on the part of the owner. Warranty is also invalid in any case that the product is taken apart or serviced by an unauthorized service station.

This warranty gives you specific legal rights which may vary from state to state and does not cover areas outside the United States.

AROMA HOUSEWARES COMPANY  
6469 Flanders Drive  
San Diego, California 92121  
1-800-276-6286  
M-F, 8:30 AM - 5:00 PM, Pacific Time  
Website: [www.aromaco.com](http://www.aromaco.com)