

AROMA[®]

600 Series Professional Blender

Instruction Manual



www.AromaCo.com

ABD-520BD

Please read all the instructions before first use.

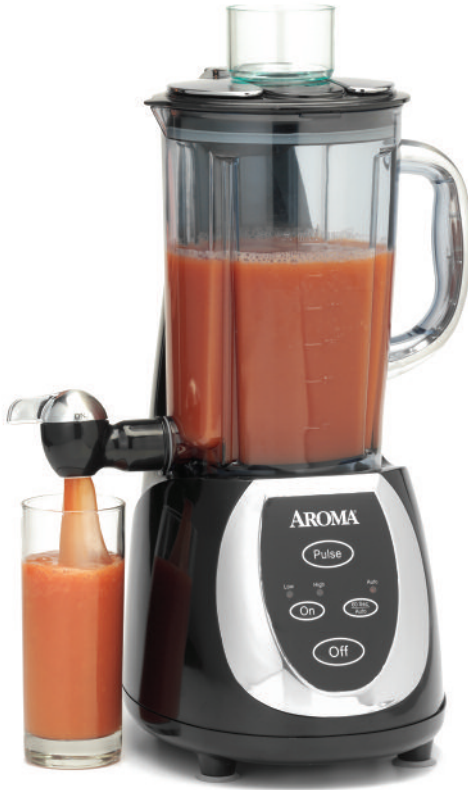

Published By:

Aroma Housewares Co.
6469 Flanders Drive
San Diego, CA 92121
U.S.A.
1-800-276-6286
www.aromaco.com

© 2007 Aroma Housewares Company All rights reserved.

IMPORTANT SAFEGUARDS

Basic safety precautions should always be followed when using electrical appliances, including the following:

1. Read all instructions before operating.
2. To protect against risk of electrical shock, do not put blender in water or other liquid.
3. This appliance should not be used by children and care should be taken when used near children.
4. Unplug from outlet when not in use, before putting on or taking off parts and before cleaning.
5. Avoid contact with moving parts.
6. Do not operate any appliance with a damaged cord or plug or after the appliance malfunctions or is dropped or damaged in any manner. Return appliance to the nearest authorized service facility for examination, repair, or electrical or mechanical adjustment.
7. The use of attachments, including canning jars, not recommended or sold by the manufacturer may cause fire, electric shock, or injury.
8. Do not use outdoors.
9. Do not let cord hang over edge of table or counter.
10. Do not let cord contact hot surfaces, including the stove.
11. Keep hands and utensils out of blender container while processing to prevent the possibility of severe personal injury and/or damage to the blender. A scraper may be used, but must only be used when the blender is not running.
12. Blades are sharp. Handle carefully.
13. To avoid injury, never place blade assembly on the base without container properly attached.
14. Always operate blender with cover in place.
15. Do not immerse in water.

SAVE THESE INSTRUCTIONS

POLARIZED PLUG

This appliance has a polarized plug (one blade is wider than the other); follow the instructions below:

To reduce the risk of electric shock, this plug is intended to fit into a polarized outlet only one way. If plug does not fit fully into the outlet, reverse the plug. If it still does not fit, contact a qualified electrician. Do not attempt to modify the plug in any way.

SHORT CORD INSTRUCTIONS

1. A short power-supply cord is provided to reduce risk resulting from becoming entangled in or tripping over a longer cord.
2. Longer extension cords are available and may be used if care is exercised in their use.
3. If a longer extension cord is used:
 - a. The marked electrical rating of the extension cord should be at least as great as the electrical rating of the appliance.
 - b. The longer cord should be arranged so that it will not drape over the counter top or tabletop where it can be pulled by children or tripped over unintentionally.



This appliance is for household use only.

CAUTION

1. Use this product with rated voltage AC outlet only.
2. Be sure to unplug the AC cord when blender is not being used.

SAFETY CONSIDERATIONS

1. Do not open the lid of the blender until the blades have stopped turning.
2. Unplug the cord after each use.
3. Do not submerge the base of the blender in water or other liquids. The base is NOT dishwasher safe.
4. Do not place hard objects into this machine such as hard fruit pits (i.e. peach or avocado pits).
5. Make sure that the blender and motor assembly are firmly affixed to the blender base before turning on the blender.
6. Blades are extremely sharp. Always use a spoon or spatula to remove food from the blender.
7. Always remove the carafe from the blender base before scrubbing.

PARTS IDENTIFICATION

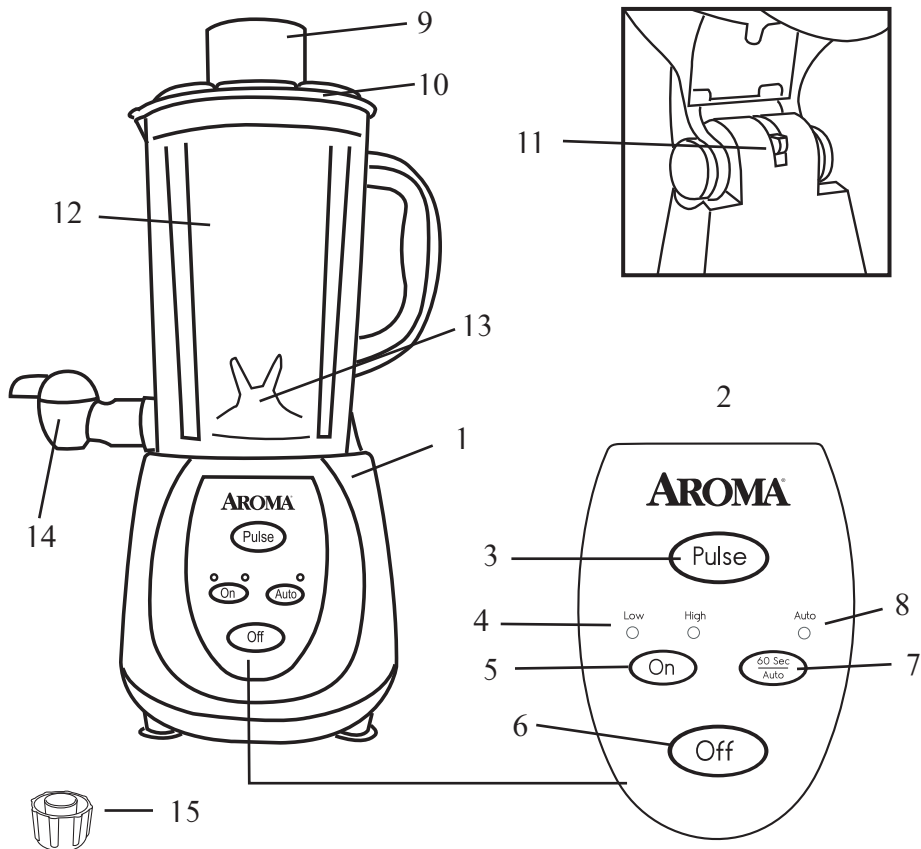

1. Blender base
2. Digital control panel
3. Pulse button
4. Low / High speed indicator lights
5. On button
6. Off button
7. 60-second Pulse & Pulverize™ button
8. Auto indicator light
9. Detachable lid cap
10. Removable lid
11. Hinged safety switch
12. Polycarbonate carafe
13. Hexa-Blade™ assembly
14. Dispensing spigot
15. Side cap

USING YOUR BLENDER

Before First Use

1. Read all instructions and important safeguards.
 2. Remove all packaging materials and make sure items are in good condition.
 3. Tear up all plastic bags as they can pose a risk to children.
 4. Wash lid, lid cap, carafe and blade assembly in warm soapy water. Rinse and dry thoroughly.
 5. Wipe blender base with a soft, damp cloth.
- Do not use abrasive cleaners or scouring pads.
 - Do not immerse blender base, cord or plug in water at any time

To Operate Your Blender

1. Place blender base on a sturdy, level surface.
2. Attach the side cap or the dispensing spigot to the side of the carafe by screwing on clockwise. When using the dispensing spigot, make sure that the knob is turned to the OFF position.
3. Place carafe into the blender base, gently turning side to side to ensure that the undercarriage of the carafe lines up properly with the base.
4. Place ingredients into the carafe.
5. Attach the lid cap to the lid by lining up the two pegs on the bottom with the indentations in the lid and turning clockwise to lock in place. (See Diagram 1)
6. Slide the lid onto the hinged safety switch (see diagram 2) and close the lid, making sure that it fits snugly onto the carafe.
7. Plug the power cord into a wall outlet.
8. To operate:

Diagram 1

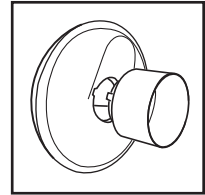
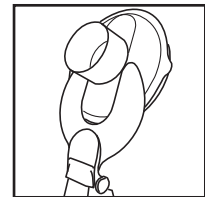

Diagram 2



PULSE

Press and release the Pulse button as needed to pulse at high speed. The motor will stop when the Pulse button is released. This function is best for blending large chunks such as ice or frozen food, because stopping the motor allows pieces to settle closer to the blades.

USING YOUR BLENDER

LOW SPEED Press the ON button once. The “Low” indicator light will illuminate. The low speed is best for mixing soft ingredients.

HIGH SPEED Press the ON button twice. The “High” indicator light will illuminate. The high speed is best for ultra-fine blending.

PULSE & PULVERIZE™ Press the 60 Sec/Auto button. The “Auto” indicator light will illuminate. The blender will start a pre-programmed cycle. First, it will pulse ingredients in 10-second intervals, followed by 30 seconds of continuous grinding. The motor will automatically shut off after 60 seconds and a beep will sound to alert you that the cycle has finished.

9. Press the OFF button at any time to stop the motor.
10. If the lid is opened at any point during operation, the motor will stop.
11. To add ingredients during the blending cycle, turn the lid cap counter-clockwise and lift up. Carefully insert ingredients through the lid opening, and then reattach the lid cap.
12. To dispense without the dispensing spigot, press the OFF button and lift up the lid. Lift the carafe off of the blender base by the handle. Pour out ingredients into serving containers.

DISPENSING SPIGOT To use the spigot, leave the lid in place after blending. Place cup or container under the spigot. Turn the spigot knob to the ON position. Press the PULSE button to move the mixture through the spigot. Turn the handle to the OFF position when finished dispensing.

HOW TO CLEAN

Always unplug unit and allow to cool completely before cleaning.

Self-Cleaning

The dispensing spigot must be attached to the carafe in order to use the Self Clean feature.

1. Dispense contents of carafe completely.
2. Make sure that the dispensing spigot is attached to the carafe.
3. Add warm water and dish soap to the carafe.
4. Place the carafe firmly on the blender base and close the lid.
5. Press the 60 Sec/Auto button. When the cycle is complete, place a container beneath the dispensing spigot and turn the handle to the ON position. The soapy water will drain out of the carafe.
6. Turn the handle on the spigot to the OFF position.
7. Add warm water to the carafe. Close the lid and press the PULSE button a few times to rinse the inside of the carafe.
8. Place a container beneath the dispensing spigot and turn the handle to the ON position. The water will drain out of the carafe.
9. Repeat steps 6 through 8 as needed until blender is completely rinsed.
10. Allow the lid to remain open for several hours in order to let the carafe dry.

Hand Washing

1. Dispense contents of carafe completely.
2. Place carafe, lid, lid cap, dispensing spigot (in the ON position) and/or side cap into warm soapy water.
3. Wipe the carafe clean with a soft cloth, taking care not to touch the blades. It may help to collect some soapy water in the carafe and shake gently to jar loose any food particles.
4. Rinse carafe completely.
5. Wash the other accessories with a soft cloth and rinse completely.
6. Dry all parts thoroughly before storing.

BLENDING GUIDE

Tips for Getting Started

WET INGREDIENTS

This blender operates best with wet ingredients. When blending ice, frozen fruits, hard vegetables or other “dry foods”, it will help to add a small amount of water or other liquid to the carafe before blending.

SAFETY SWITCH

The motor will not operate if the lid is not firmly attached to the carafe or if the carafe is not properly aligned on the blender base. See Parts Identification on page 4 for the location of the safety switch.

ICE

When mixing ice with softer ingredients such as fruit and vegetables, it is best to place the softer foods into the carafe first and then place ice cubes on top.

JAMMING

If ice or food becomes stuck around the blades, turn the motor off. Once the blades have stopped rotating, use a spatula or other long utensil to dislodge the stuck fragment. Remove the utensil, replace the lid and restart the motor.

AUTO SHUT-OFF

The blender has an auto shut-off function which will turn off the motor after 60 seconds of operation. To continue blending after 60 seconds, press the Pulse, On, or Auto button again.

TROUBLESHOOTING

Question	Problem	Solution
The motor has stopped.	The blender has been running for 60 seconds.	The auto-shut off safety feature of this blender will stop the motor after 60 seconds of operation. To re-start the motor, simply press the Pulse, On, or Auto button as desired.
	The blade has become jammed against something in the carafe.	Press the off button. Open the lid. Using a spatula or other long-handled utensil, stir the ingredients in order to dislodge the food fragment that has become stuck. Once it is dislodged, remove the utensil, close the lid and restart the motor.
	The motor has overheated.	Open the lid and remove the carafe from the blender base. Allow the blender base to cool for 15-20 minutes. This should be adequate time for the motor to cool. Turn the blender base over and press the black button located on the underside. Replace the base, attach the carafe, close the lid and restart the motor.

If after following the instructions in the above table, your blender is still not functioning properly, please contact one of our Customer Service Representatives at 800-276-6286.

LIMITED WARRANTY

Aroma Housewares Company warrants this product free from defects in material and workmanship for one year from provable date of purchase in the continental United States.

Within this warranty period, Aroma Housewares Company will repair or replace, at its option, defective parts at no charge, provided the product is returned, freight prepaid with proof of purchase and U.S. \$12.00 for shipping and handling charges payable to Aroma Housewares Company. Before returning an item, please call the toll free number below for a return authorization number. Allow 2-4 weeks for return shipping.

This warranty does not cover improper installation, misuse, abuse or neglect on the part of the owner. Warranty is also invalid in any case that the product is taken apart or serviced by an unauthorized service station.

This warranty gives you specific legal rights and which may vary from state to state and does not cover areas outside the United States.

AROMA HOUSEWARES COMPANY
6469 Flanders Drive
San Diego, California 92121
1-800-276-6286
M-F, 8:30 AM - 5:00 PM, Pacific Time
Website: www.aromaco.com