

AROMA[®]
PROFESSIONAL



instruction manual

ACG-106

Coffee Grinder

Questions or concerns about your Aroma product?

www.AromaCo.com/Support

1-800-276-6286

**DISCOVER
more of our
products!**



Multicookers/
Rice Cookers



Pressure Cookers



Water Kettles



Indoor Grills



Induction Cooktops

AROMA®

To Enhance and Enrich Lives.

Here at Aroma we strive to make a difference—to design and distribute products that enhance and enrich people's lives.

Aroma offers an array of exceptional products to make cooking simple and satisfying. Discover other countertop appliances and cookware from our current product lineup to complement your kitchen.

Stay connected for more recipe ideas and monthly giveaways!



www.AromaTestKitchen.com



[/AromaHousewares](https://www.instagram.com/AromaHousewares)



Published By:

Aroma Housewares Co. | 6469 Flanders Drive, San Diego, CA 92121, U.S.A.

1-800-276-6286 | www.AromaCo.com

©2019 Aroma Housewares Company | All rights reserved.



IMPORTANT SAFEGUARDS

When using electrical appliances basic safety precautions should always be followed, including the following:

- 1. Read all instructions carefully before using the appliance.**
- To protect against fire, electric shock and injury to persons, do not immerse grinder, plug or cord in water or any other liquid. See instructions for cleaning.
- This grinder should not be used by or near children or individuals with certain disabilities.
- Unplug from outlet when not in use, before putting on or taking off parts, before removing coffee and before cleaning.
- Do not operate appliance with a damaged cord or plug, or after appliance malfunctions or has been damaged in any manner. Contact Aroma® customer service for examination, repair or electrical/mechanical adjustment.
- The use of accessory attachments not recommended by Aroma® Housewares may result in fire, electrical shock or injury.
- Do not use outdoors.
- Do not let cord hang over the edge of a table or counter or touch hot surfaces.
- Do not place grinder on or near a hot gas or electric burner or in a heated oven.
- Always unplug from plug gripping area. Never pull on the cord.
- Do not use grinder for other than its intended use.
- Use only on a level, dry and heat-resistant surface.
- The electric grinder should be operated on a separate electrical circuit from other operating appliances. If the electrical circuit is overloaded with other appliances the electric grinder may not operate properly.
- Use this appliance to grind roasted coffee beans only. Grinding other substances, such as nuts, spices or unroasted beans, may dull the burrs and cause poor grinding or injury.

SAVE THESE INSTRUCTIONS



IMPORTANT SAFEGUARDS

Short Cord Instructions

1. A short power-supply cord is provided to reduce the risks resulting from becoming entangled in or tripping over a longer cord.
2. Longer extension cords are available and may be used if care is exercised in their use.
3. If a longer extension cord is used:
 - a.) The marked electrical rating of the extension cord should be at least as great as the electrical rating of the appliance.
 - b.) The longer cord should be arranged so that it will not drape over the counter top or tabletop where it can be pulled by children or tripped over unintentionally.

DO NOT DRAPE CORD!

**KEEP AWAY
FROM CHILDREN!**

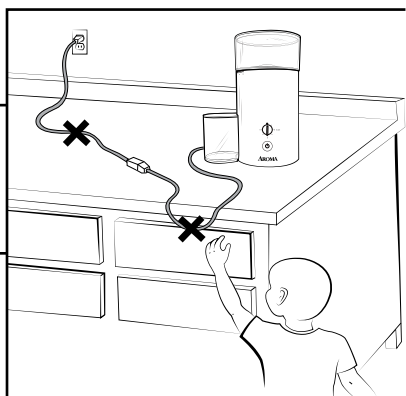

Polarized Plug

This appliance has a polarized plug (one blade is wider than the other); follow the instructions below:

To reduce the risk of electric shock, this plug is intended to fit into a polarized outlet only one way. If the plug does not fit fully into the outlet, reverse the plug. If it still does not fit, contact a qualified electrician. Do not attempt to modify the plug in any way.

If the supply cord is damaged, it must be replaced by the manufacturer, its service agent or a similarly qualified person in order to avoid a hazard.

THIS APPLIANCE IS FOR HOUSEHOLD USE ONLY.

Parts Identification

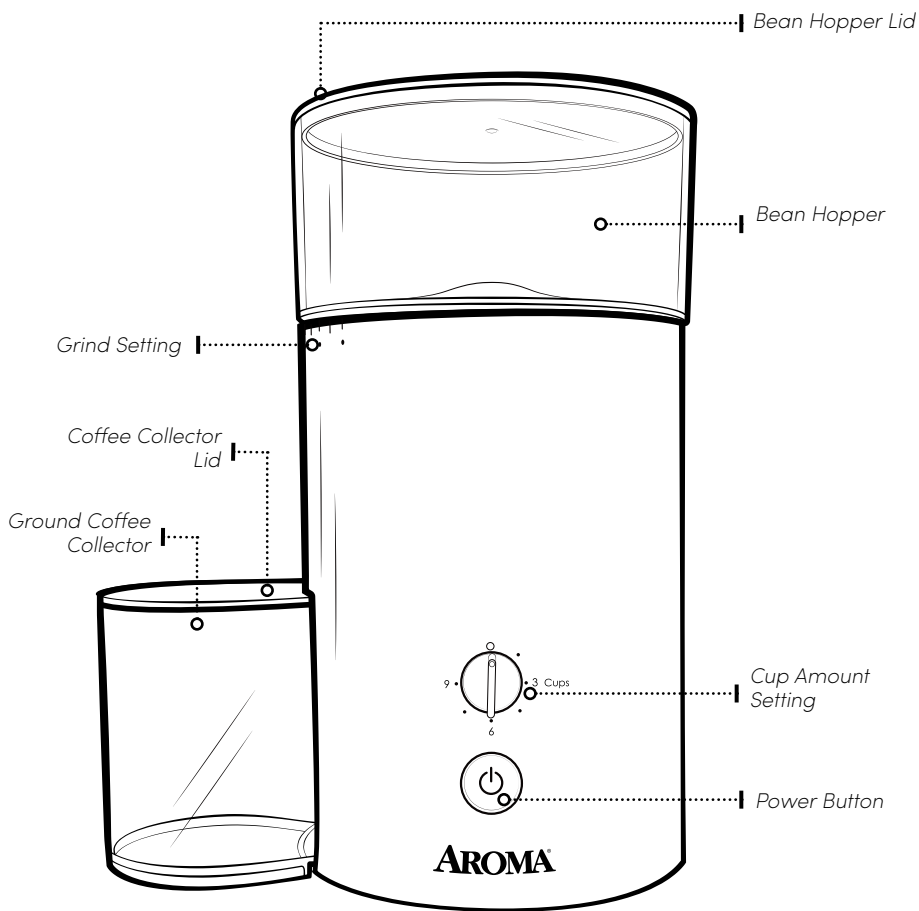

Controls/Functions

Power Button

Turns the power on and off.

Grind Setting

Allows you to choose between 9 grind settings from fine to coarse.

Cup Amount Setting

Choose the amount of cups you would like grinds for.

BEFORE FIRST USE

1. **Read all instructions and important safeguards.**
2. Remove all packing materials and make sure that the product has been received in good condition.
3. Take care to keep the electrical components on the exterior of the coffee grinder dry. Wipe the exterior of the coffee grinder and inside the **Bean Hopper** with a damp cloth.
4. Remove the **Hopper** by slowly twisting it in a counter-clockwise direction to align the indicator line on the clear plastic with the dot on the grinder. Lift the **Bean Hopper** from the grinder.
5. Wash the **Hopper, Lid, and Ground Coffee Collector** with warm soapy water. Rinse and dry thoroughly, then replace onto the grinder.
.....

TO CLEAN

1. Unplug the grinder from the wall.
2. Wipe the exterior of the grinder with a damp cloth.
3. Remove any remaining beans from the **Hopper**. Remove the **Hopper** by slowly twisting it in a counter-clockwise direction to align the indicator line on the clear plastic with the dot on the grinder. Lift the **Bean Hopper** from the grinder.
4. Wash the **Hopper, Lid, and Ground Coffee Collector** with warm soapy water. Rinse and dry thoroughly.
5. Remove the upper cone burr on the grinder by lifting it straight up. Use the **Cleaning Brush** to remove any loose coffee residue, as well as brush the lower burr mounted in the grinder.
6. Reassemble the burr by lining up the three bulges on the burr with the three slots in the holder, push into place.
7. Replace the **Hopper** by lining up the indicator line with the dot, then turning clockwise into position.
8. **NOTE:** you do not need to clean the grinder after each use.
.....

Note:

- Never attempt to disassemble the coffee grinder
- Never immerse the grinder, power cord or plug in water.
- Always take care not to allow electrical components to come into contact with water.
- Do not use abrasive cleaners or scouring pads of any kind on the appliance. This will cause damage to the finish and may create a risk of electrical shock.
- Any other servicing should be performed by Aroma® Housewares.



Caution:

Always unplug the grinder and allow it to cool completely before cleaning.

TIPS

- Keep the **Bean Hopper Lid** sealed to keep the coffee beans fresh for best aroma.
 - Fill the desired amount of coffee beans for each use to keep them fresh. Leaving excess beans in the **Hopper** will result in less delicious coffee.
 - For Filter/Drip coffee, use a **coarse** Grind Setting.
 - For a coffee pot, use **medium** Grind Setting.
 - For espresso, use **fine** Grind Setting.
 - If the grinder is used daily, clean the burrs every few weeks.
 - Always make sure the **Ground Coffee Collector** is fully inserted into the grinder. If it is not in place, the grinder will not work.
-

TO GRIND COFFEE

1. Plug grinder into an available 120V AC wall outlet.
 2. Remove the **Lid** and pour in the desired amount of roasted coffee beans. Replace the **Lid**.
 3. Push the **Ground Coffee Collector** into the grinder all of the way. If it is not inserted, the machine will not work.
 4. Rotate the **Bean Hopper** to choose the grinding level.
 5. Adjust the **Cup Amount Setting** to the desired amount. You should grind only for the amount of cups you wish to prepare and not more, as coffee is always better freshly ground.
 6. Press the **Power Button** to start grinding the coffee beans. It will automatically stop once the amount selected is reached. Or, you can stop grinding manually by pressing the **Power Button** again.
 7. Remove the **Ground Coffee Collector** and use it to make your coffee.
-

Note:

- To manually stop grinding, press the **Power Button**.
- For help on which fineness setting to choose, see "Grinding Table" on page **8**.

Grinding Table

Fineness Selector

Grind	Ground Coffee Fineness Selector
Fine	Smallest dot
Medium	Middle dot
Coarse	Largest dot

Note:

- Do not change the grind setting while the appliance is running

Helpful Hints:

For the first use, we suggest that you use an intermediate position and then adjust the grind setting to your taste. Once you have used the appliance a few times, you will find the ideal grind setting to suit your taste and brew method.

LIMITED WARRANTY

Aroma Housewares Company warrants its products against defects in material and workmanship for two years from provable date of purchase in the United States.

Within this warranty period, Aroma Housewares Company will repair or replace, at its discretion, defective parts at no charge, provided the product is returned, freight prepaid with proof of purchase and U.S. \$15.00 for shipping and handling charges payable to Aroma Housewares Company. Before returning an item, please call the toll free number below for a return authorization number. Allow 2-4 weeks for return shipping.

This warranty does not apply if the warranty period expired; the products has been modified by any unauthorized service center or personnel; the defect was subject to abuse, improper use not conforming to product manual instructions, or environment conditions more severe than those specified in the manual and specification, neglect of the owner or improper installation; the defect was subject to Force Majeure such as flood, lightning, earthquake, other natural calamities, war, vandalism, theft, brownouts or sags (damage due to low voltage disturbances).

This warranty gives you specific legal rights, which may vary from state to state, and does not cover areas outside the United States.

.....

SERVICE & SUPPORT

In the event of a warranty claim, or if service is required for this product, please contact Aroma® customer service toll-free at:

1-800-276-6286

M-F, 8:30am-4:30pm, Pacific Time

Or we can be reached online at:

CustomerService@AromaCo.com

For your records, we recommend stapling your sales receipt to this page along with a written record of the following:

· Date of Purchase:

· Place of Purchase:

.....

Aroma Housewares Company
6469 Flanders Drive, San Diego, CA 92121, U.S.A.

1-800-276-6286 | www.AromaCo.com

M-F, 8:30am – 4:30pm, Pacific Time

Note:

· Proof of purchase is required for all warranty claims.



To Enhance and Enrich Lives.



www.AromaCo.com