

# AROMA®

## Pasta Plus™

Electric Water Kettle and Pasta Cooker

Instruction Manual



[www.AromaCo.com](http://www.AromaCo.com)

AWK-160SB

For recipe suggestions or more kitchen solution ideas, please visit us online at [www.AromaCo.com](http://www.AromaCo.com)

Please read all the instructions before first use.



Published By:

Aroma Housewares Co.  
6469 Flanders Drive  
San Diego, CA 92121  
U.S.A.  
1-800-276-6286  
[www.aromaco.com](http://www.aromaco.com)

© 2007 Aroma Housewares Company All rights reserved.

# IMPORTANT SAFEGUARDS

*Basic safety precautions should always be followed when using electrical appliances, including the following:*

1. Read all instructions before using.
2. Before connecting the appliance to the power supply, check that the voltage indicated on the appliance (underside the appliance & base) corresponds with the voltage in your home. If this is not the case, contact your dealer and do not use the cooker.
3. If the supply cord is damaged, it must be replaced by the manufacturer or its service agent or a similarly qualified person in order to avoid a hazard.
4. Do not let the cord hang over the edge of a table or counter or to touch a hot surface.
5. Do not place on or near a hot gas or electric burner or in a heated oven.
6. Do not operate without water; otherwise the heating element may be damaged.
7. Ensure that the appliance is used on a firm and flat surface and out of reach of children in order to prevent overturning the cooker and causing personal injury or damage to the cooker.
8. To protect against fire, electric shock or personal injury, do not immerse cord, electric plugs or cooker in water or other liquids.
9. Avoid contact with steam from the spout while the water is boiling or shortly after it has switched off. Open the lid carefully.
10. Always take care to pour boiling water slowly and carefully without tipping the cooker to fast.
11. Close supervision is necessary when any appliance is used by or near children.
12. Do not touch hot surfaces. Use handles or knobs.
13. Extreme caution must be taken when moving an appliance containing hot water, oil or other hot liquids.
14. Unplug from outlet when not in use and before cleaning. Allow to cool down before putting on or taking off parts and before cleaning the appliance.
15. Always ensure the lid is closed and do not lift the lid while the water is boiling. Scalding may occur if the lid is removed during boiling cycles.
16. Do not use this appliance for other than its intended use.
17. The use of accessory attachments not recommended by the manufacturer may result in fire, electric shock, or injury to persons.
18. Do not operate any appliance with a damaged cord or after the appliance malfunctions or has been damaged in any manner. Return appliance to the nearest authorized service facility for examination, repair, or adjustment.
19. Do not use outdoors.
20. To disconnect, turn any control to "off" and then remove plug from wall outlet.
21. Do not boil harsh chemical liquids in this appliance.

## SAVE THESE INSTRUCTIONS

## SHORT CORD INSTRUCTIONS

1. A short power-supply cord is provided to reduce risk resulting from becoming entangled in or tripping over a longer cord.
2. Longer extension cords are available and may be used if care is exercised in their use.
3. If a longer extension cord is used:
  - a. The marked electrical rating of the extension cord should be at least as great as the electrical rating of the appliance.
  - b. The longer cord should be arranged so that it will not drape over the counter top or tabletop where it can be pulled by children or tripped over unintentionally.

## GROUNDING INSTRUCTIONS

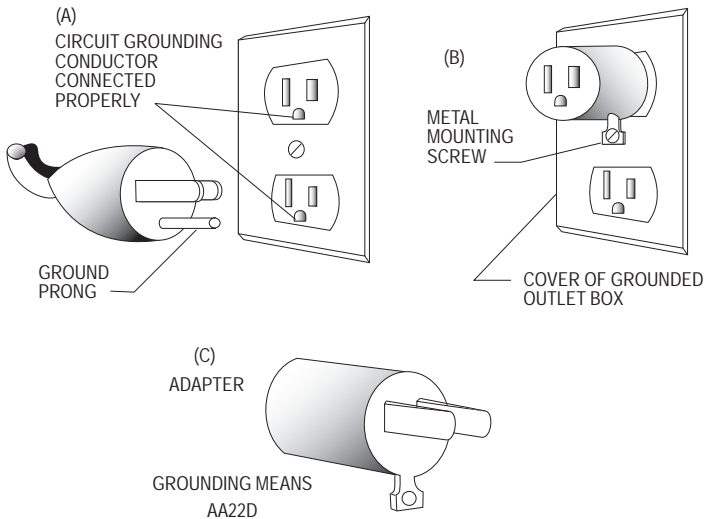

This appliance must be grounded while in use to protect the operator from electrical shock. The appliance is equipped with a 3-conductor cord and a 3-prong grounding-type plug to fit the proper grounding-type receptacle. The appliance has a plug that looks like sketch A. An adapter, sketch B, should be used for connecting sketch-A plug plugs to two-plugs to two-prong receptacles. The grounding tab, which extends from the adapter, must be connected to a permanent ground such as a properly grounded outlet box as shown in sketch C using a metal screw.

**This appliance is for household use only.**

# PARTS IDENTIFICATION

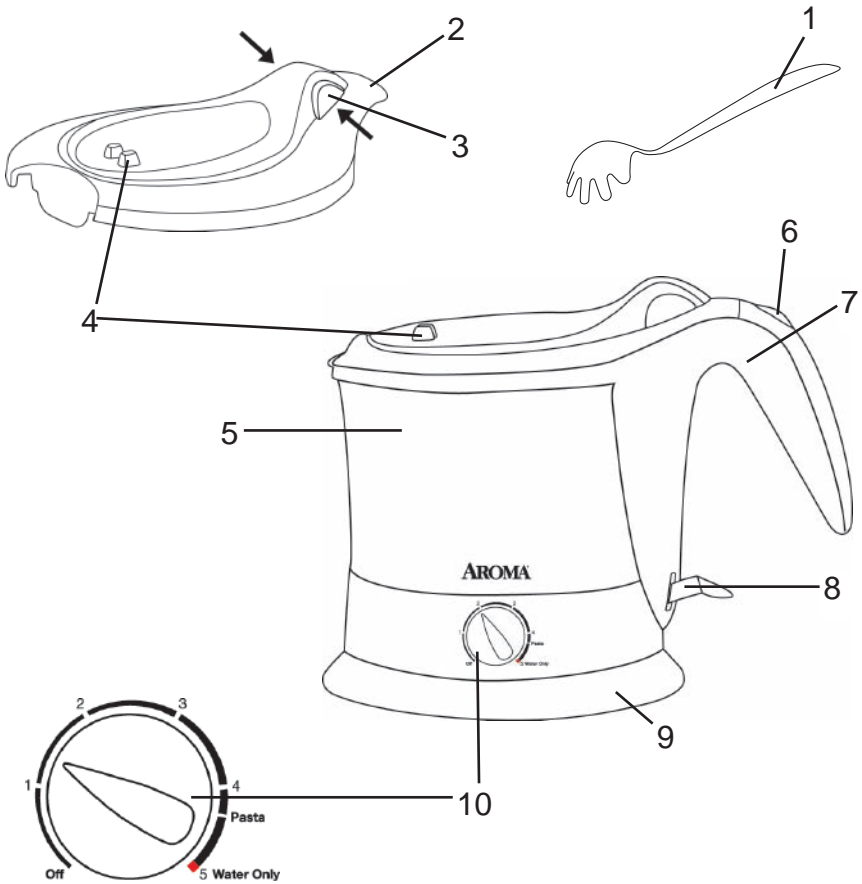

1. Pasta Fork
2. Lid
3. Lid Release Button
4. Pasta Fork Holder
5. Stainless Steel Housing
6. ON Indicator Light
7. Cool-Touch Handle
8. Power Switch
9. Power Base
10. Temperature Knob

# USING YOUR PASTA PLUS™

## Notes On Operating your Pasta Plus™

---

### Settings 1-4

These settings are used for continuous heat, such as warming soups or boiling pasta. Do not use the lid when doing this type of cooking. NOTE: The cooker will remain ON until the temperature dial is turned to 0 and the power switch is lifted up. Also, the indicator light may come on and off when using these settings. This is normal as the heating element adjusts to maintain the selected temperature. Please note that the power is always on during use and that close supervision is necessary.

### Water Only Setting (5)

This setting is for boiling water only. Always use the lid when boiling water. When the water has come to a rolling boil, the power will automatically switch off.

### Boil-Dry Protection

Should the cooker accidentally be switched on without water or soup inside, the boil-dry protection will automatically switch the power to OFF. If this should occur, allow the cooker to cool before using again.

### Minimum/Maximum Lines

The cooker must contain water or soup at a level between these two lines in order to function properly. If the water level is beneath the MIN line, the cooker will shut off. If the water is above the MAX line, it may boil over and cause injuries.

### Lid

Only use the lid when using setting 5 – Water Only. Do not use the lid when warming soups or boiling pasta.

# USING YOUR PASTA PLUS™

## Before First Use:

---

1. Wipe out the interior with a damp, soapy cloth. Rinse and dry thoroughly, taking care not to let water come into contact with the electrical components on the bottom of the cooker.
2. Wash lid and pasta fork in warm soapy water. Rinse and dry thoroughly.
3. Wipe stainless steel exterior and power base with a damp cloth, taking care not to touch the electrical components. Dry thoroughly.
4. It is recommended that you allow a full pot of water to come to a boil inside the cooker twice and rinse thoroughly before placing food in the cooker. Refer to the section titled “How to Use” for boiling instructions.

## Boiling Water:

---

1. Remove the pot from the power base.
2. Remove the lid by pressing in on the two lid release buttons and lifting up.
3. Fill the pot with water. Do not fill below the MIN line or above the MAX line in order to avoid damage to the cooker and personal injury.
4. Replace the lid onto the pot by pressing in on the lid release buttons and setting it into place. Ensure that the lid is firmly locked into place.
5. Place the pot onto the power base. Turn the temperature knob to the 5 - WATER ONLY position.
6. Connect the plug into a functioning wall outlet.
7. Press down on the power switch. The indicator light will illuminate.
8. When the water has come to a boil, the power switch will pop up and the indicator light will turn off.
9. Carefully lift the pot from the power base by the cool-touch handle. Stainless steel exterior will be hot.

**NOTE:** *Do not open the lid right after the water has come to a boil. Instead, pour through the spout opening. Opening the lid before the water has cooled poses a risk of scalding and steam burns.*

10. Unplug the power cord from the wall outlet when not in use.

# USING YOUR PASTA PLUS™

## Boiling Noodles:

---

1. Add water to the pot, taking care not to fill under the MIN line or exceed the MAX line.
2. Carefully place the pot onto the power base. Do not place the lid onto the pot.
3. Plug the power cord into a functioning wall outlet.
4. Turn the temperature dial to the Pasta setting.
5. Allow the water to come to a boil. Meanwhile, place pasta in the colander. Do not fill colander more than halfway full, as pasta will expand during cooking.

**NOTE:** *For longer noodles, such as spaghetti, we recommend that you break the noodles in half and place them in the colander. Once they are placed in the boiling water and begin to soften, they can be stirred until they are fully submerged in water.*

6. When the water has begun to boil, carefully place the colander into the pot, holding it by the handle.
7. Allow the noodles to boil for the required amount of time (refer to the instructions on the pasta packaging). Stir occasionally with the pasta fork.
8. When the noodles have finished, turn the temperature dial to 0 and pull up the power switch.
9. Carefully lift the colander from the pot. **WARNING:** Colander and colander handle will be hot. It is best to use the pasta fork or an oven mitt when lifting the colander. You may also wait a few minutes for the colander to cool, but care should still be taken to avoid burns.
10. Empty the noodles into a heat-safe bowl or container.
11. Empty the used water from the pot into a sink.
12. Unplug the power cord from the wall outlet when not in use.

## Instant Noodles:

---

1. Add water to the pot according to package instructions, taking care not to fill under the MIN line or exceed the MAX line.
2. Carefully place the pot onto the power base. Do not place the lid onto the pot.
3. Plug the power cord into a functioning wall outlet.
4. Turn the temperature dial to the Pasta setting.
5. Allow the water to come to a boil.
6. When the water has begun to boil, carefully place the noodles (you may choose to use the colander if you like) into the pot.



# USING YOUR PASTA PLUS™

## Instant Noodles (continued):

7. Allow the noodles to boil for the required amount of time (refer to the instructions on the pasta packaging). Stir occasionally with the pasta fork.
8. When the noodles have finished, turn the temperature dial to 0 and pull up the power switch.
9. If not using the colander, carefully pour noodles and water into a heat-safe bowl or container.
10. If using the colander, carefully lift the colander from the pot and empty the noodles into a heat-safe bowl or container. **WARNING:** Colander and colander handle will be hot. It is best to use the pasta fork or an oven mitt when lifting the colander. You may also wait a few minutes for the colander to cool, but care should still be taken to avoid burns.
11. Unplug the power cord from the wall outlet when not in use.

## Warming Soups/Stews:

1. Add soup or stew to the pot, taking care not to fill under the MIN line or exceed the MAX line.
2. Carefully place the pot onto the power base. Do not place the lid onto the pot.
3. Plug the power cord into a functioning wall outlet.
4. Turn the temperature dial between settings 2 and 4, depending on the type and thickness of your soup. Stir often and check for over-bubbling or burning. If either of these occurs, the temperature setting is too high.
5. Allow the contents of the pot to warm to the desired temperature, stirring occasionally.
6. If bubbling or sputtering occurs, turn the temperature dial to a lower setting.
7. When food has finished warming, turn the temperature dial to zero and pull up the power switch.
8. Lift the pot from the power base by the cool touch handle and carefully pour the contents into a heat-safe container.
9. Unplug the power cord from the wall outlet when not in use.

# USING YOUR PASTA PLUS™

## **Re-Heating/Warming:**

---

1. To reheat soups, stews or noodles, place them back into the pot. If you are reheating pasta, add enough water to cover the noodles.
2. Place the pot onto the power base and plug the power cord into a functioning wall outlet.
3. Turn the temperature dial to 1.
4. Allow the contents of the pot a few moments to heat up. If more heat is desired, turn up the temperature knob until the desired temperature is reached. Never turn the temperature knob to setting 5 when heating soups or pasta.
5. The cooker will remain on until the temperature knob is turned to 0 and the power switch is pulled up. Close supervision is necessary during operation.
6. Unplug the power cord from the wall outlet when not in use.

## **Instant Pasta with Butter or Milk:**

---

1. Follow package instructions, taking care to monitor for burning or over-bubbling and adjusting temperature settings as necessary.
2. Cook with pot uncovered. Do not use the lid.
3. Unplug the power cord from the wall outlet when not in use.

# HOW TO CLEAN

*Always unplug unit and allow to cool completely before cleaning.*

1. Empty contents from the pot completely.
  2. Wash out the interior of the stainless steel pot with warm, soapy water and a soft cloth. Take care not to let water come into contact with the electrical components on the underside of the pot.
  3. Rinse and dry thoroughly.
  4. Wash lid and pasta fork in warm, soapy water. Rinse and dry thoroughly.
  5. With a damp, soft cloth, wipe the power base and the exterior of the pot clean. Take care not to let water or wet towel come into contact with electrical components.
  6. The lid may be stored on the pot. The pot may be stored on the power base. The pasta fork may be stored in its holder on top of the lid.
  7. Always leave the Pasta Plus™ unplugged when not in use.
- Do not use harsh abrasive cleaners or products.
  - This appliance is NOT dishwasher safe. Cooking pot, colander, and accessories are to be hand-washed only.
  - Do not let electrical components come into contact with water.
  - Do not submerge power base, cord or plug in water or any other liquids.

# LIMITED WARRANTY

Aroma Housewares Company warrants this product free from defects in material and workmanship for one year from provable date of purchase in the continental United States.

Within this warranty period, Aroma Housewares Company will repair or replace, at its option, defective parts at no charge, provided the product is returned, freight prepaid with proof of purchase and U.S. \$10.00 for shipping and handling charges payable to Aroma Housewares Company. Before returning an item, please call the toll free number below for a return authorization number. Allow 2-4 weeks for return shipping.

This warranty does not cover improper installation, misuse, abuse or neglect on the part of the owner. Warranty is also invalid in any case that the product is taken apart or serviced by an unauthorized service station.

This warranty gives you specific legal rights and which may vary from state to state and does not cover areas outside the United States.

AROMA HOUSEWARES COMPANY  
6469 Flanders Drive  
San Diego, California 92121  
1-800-276-6286  
M-F, 8:30 AM - 5:00 PM, Pacific Time  
Website: [www.aromaco.com](http://www.aromaco.com)