

AROMA®



instruction manual

AWT-106B

Gravy Warmer

Questions or concerns about your Aroma product?

www.AromaCo.com/Support

1-800-276-6286

**DISCOVER
more of our
products!**



Multicookers/
Rice Cookers



Pressure Cookers



Water Kettles



Indoor Grills



Induction Cooktops

AROMA®

To Enhance and Enrich Lives.

Here at Aroma we strive to make a difference—to design and distribute products that enhance and enrich people's lives.

Aroma offers an array of exceptional products to make cooking simple and satisfying. Discover other countertop appliances and cookware from our current product lineup to complement your kitchen.

Stay connected for more recipe ideas and monthly giveaways!



www.AromaTestKitchen.com



[/AromaHousewares](https://www.instagram.com/AromaHousewares)



Published By:

Aroma Housewares Co. | 6469 Flanders Drive, San Diego, CA 92121, U.S.A.

1-800-276-6286 | www.AromaCo.com

©2018 Aroma Housewares Company | All rights reserved.



IMPORTANT SAFEGUARDS

Basic safety precautions should always be followed when using electrical appliances, including the following:

1. **Important: Read all instructions carefully before first use.**
2. Do not touch hot surfaces. Use the handles or knobs.
3. Use only on a level, dry and heat-resistant surface.
4. To protect against fire, electric shock and injury to persons, do not immerse cord, plug or the appliance in water or any other liquid. See instructions for cleaning.
5. Close supervision is necessary when the appliance is used by or near children.
6. Unplug from outlet when not in use and before cleaning. Allow unit to cool before putting on or taking off parts and before cleaning the appliance.
7. Do not operate any appliance with a damaged cord or plug or after the appliance malfunctions or has been damaged in any manner. Contact Aroma® customer service for examination, repair or adjustment.
8. The use of accessory attachments not recommended by Aroma® Housewares may result in fire, electrical shock or injury.
9. Do not use outdoors.
10. Do not let cord touch hot surfaces or hang over the edge of a counter or table.
11. Do not place on or near a hot gas or electric burner or in a heated oven.
12. Do not use the appliance for other than its intended use.
13. Extreme caution must be used when moving the appliance containing hot liquids.
14. Use only with a 120V AC power outlet.
15. Always unplug from the plug gripping area. Never pull on the cord.
16. Use extreme caution when opening the lid during or after warming. Hot steam will escape and may cause scalding.
17. To disconnect remove the plug from the wall outlet.
18. Do not wrap or tie cord around appliance.
19. Intended for countertop use only.
20. Always attach plug to appliance first, then plug cord into the wall outlet.
21. **CAUTION:** The warming surface will remain warm after the unit is turned off.
22. Always unplug and let the unit cool completely before cleaning.

SAVE THESE INSTRUCTIONS



IMPORTANT SAFEGUARDS

Short Cord Instructions

1. A short power-supply cord is provided to reduce the risks resulting from becoming entangled in or tripping over a longer cord.
2. Longer extension cords are available and may be used if care is exercised in their use.
3. If a longer extension cord is used:
 - a.) The marked electrical rating of the extension cord should be at least as great as the electrical rating of the appliance.
 - b.) The longer cord should be arranged so that it will not drape over the countertop or tabletop where it can be pulled by children or tripped over unintentionally.

DO NOT DRAPE CORD!

**KEEP AWAY
FROM CHILDREN!**

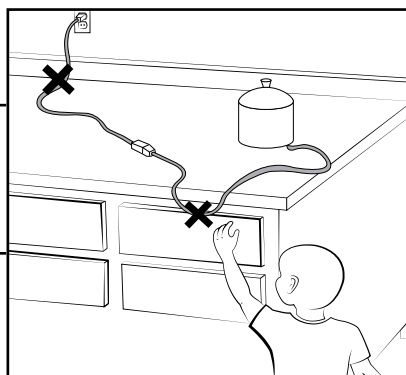

Polarized Plug

This appliance has a polarized plug (one blade is wider than the other); follow the instructions below:

To reduce the risk of electric shock, this plug is intended to fit into a polarized outlet only one way. If the plug does not fit fully into the outlet, reverse the plug. If it still does not fit, contact a qualified electrician. Do not attempt to modify the plug in any way.

If the supply cord is damaged, it must be replaced by the manufacturer, its service agent or a similarly qualified person in order to avoid a hazard.

THIS APPLIANCE IS FOR HOUSEHOLD USE ONLY.

Parts Identification



Controls/Functions

Indicator Light

The light illuminates to indicate that it is heating.

BEFORE FIRST USE

1. **Read all instructions and important safeguards.**
2. Remove all packaging materials and check that all items have been received in good condition.
3. Tear up all plastic bags and dispose of them properly as they can pose a risk to children.
4. Wash the ceramic body and lid in hot soapy water with a soft cloth or sponge.
CAUTION: Do not immerse the base in water.
5. Rinse thoroughly and dry completely.
6. Wipe ceramic base clean with damp cloth.
.....

TO CLEAN

1. Ensure the unit is switched off, the plug removed from the power outlet, and has cooled completely before cleaning.
2. Wash the lid and ceramic body in hot soapy water with a soft cloth or sponge.
3. Rinse thoroughly and dry completely.
.....

USING YOUR GRAVY WARMER

1. Prepare recipe according to instructions.
2. Remove the ceramic gravy body from the warmer base. Grasp lid knob to pull up and off.
3. Fill the ceramic body $\frac{3}{4}$ full with gravy/sauce/syrup.
4. Cooled and previously prepared gravy/sauce/syrup may be warmed in the ceramic body. Add the lid and microwave on HIGH in 1 minute increments, stirring as needed.
5. Place ceramic body back to the ceramic base.
6. Attach plug to appliance first, then plug cord into a 120V AC electrical outlet. The power ON indicator light will illuminate.
7. The ceramic gravy warmer will keep gravy/sauce/syrup at perfect serving temperature for up to 30 minutes after being unplugged.
8. Follow instructions **To Clean**.
.....

Note:

- Do not use abrasive scouring pads or powders.



Caution:

- Do not fill the ceramic gravy boat to the top with food. Over-filling could cause heated gravy/sauce/syrup to overflow and cause damage to the unit.
- **CERAMIC BASE WILL GET HOT DURING USE. TO MOVE, USE POT HOLDERS OR OVEN MITTS TO CAREFULLY GRASP WARMER BASE.**
- **ALWAYS UNPLUG GRAVY WARMER FROM WALL OUTLET WHEN NOT IN USE.**

LIMITED WARRANTY

Aroma Housewares Company warrants its products against defects in material and workmanship for one year from provable date of purchase in the United States.

Within this warranty period, Aroma Housewares Company will repair or replace, at its discretion, defective parts at no charge, provided the product is returned, freight prepaid with proof of purchase and U.S. \$15.00 for shipping and handling charges payable to Aroma Housewares Company. Before returning an item, please call the toll free number below for a return authorization number. Allow 2-4 weeks for return shipping.

This warranty does not apply if the warranty period expired; the product has been modified by any unauthorized service center or personnel; the defect was subject to abuse, improper use not conforming to product manual instructions, or environmental conditions more severe than those specified in the manual and specification, neglect of the owner or improper installation; the defect was subject to Force Majeure such as flood, lightning, earthquake, other natural calamities, war, vandalism, theft, brownouts or sags (damage due to low voltage disturbances).

This warranty gives you specific legal rights, which may vary from state to state, and does not cover areas outside of the United States.

.....

SERVICE & SUPPORT

In the event of a warranty claim, or if service is required for this product, please contact Aroma® customer service toll-free at:

1-800-276-6286

M-F, 8:30am-4:30pm, Pacific Time

Or we can be reached online at:

CustomerService@AromaCo.com

For your records, we recommend stapling your sales receipt to this page along with a written record of the following:

· Date of Purchase:

· Place of Purchase:

.....

Aroma Housewares Company
6469 Flanders Drive, San Diego, CA 92121, U.S.A.

1-800-276-6286 | www.AromaCo.com

M-F, 8:30am – 4:30pm, Pacific Time

Note:

· Proof of purchase is required for all warranty claims.



To Enhance and Enrich Lives.



www.AromaCo.com