

GOT RICE?TM

Rice Cooker



Instruction Manual

GRC-023

Congratulations on your purchase of the **GOT RICE?** Rice Cooker. It will surely become one of the most useful and versatile appliances in your modern kitchen.

Please read all instructions before your first use.



Published By:

Aroma Housewares Co.
6469 Flanders Drive
San Diego, CA 92121
U.S.A.
1-800-276-6286
www.aromaco.com

© 2006 Aroma Housewares Company All rights reserved.

IMPORTANT SAFEGUARDS

Basic safety precautions should always be followed when using electrical appliances, including the following:

1. Important: Read all instructions carefully before first use.
2. Do not touch hot surfaces. Use handles or knobs.
3. To protect against electrical shock, do not immerse cord, plug or the appliance itself in water or other liquid.
4. Close supervision is necessary when the appliance is used by or near children.
5. Unplug from outlet when not in use and before cleaning. Allow unit to cool before putting on or taking off parts, and before cleaning the appliance.
6. Do not operate any appliance with a damaged cord or plug or after the appliance malfunctions or has been damaged in any manner. Return appliance to the nearest authorized service facility for examination, repair or adjustment.
7. Do not use attachments or accessories other than those supplied or recommended by the manufacturer. Incompatible parts create a hazard.
8. Do not use outdoors.
9. Do not let cord hang over edge of table or counter, or touch hot surfaces.
10. Do not place on or near a hot burner or in a heated oven.
11. Do not use the appliance for other than intended use.
12. Do not clean with metal scouring pads. Pieces can break off the pad and touch electrical parts, creating a risk of electric shock. Metal-scouring pads may also damage the finish.
13. Always unplug from the base of the wall outlet. Never pull on the cord.
14. The rice cooker should be operated on a separate electrical circuit from other operating appliances. If the electric circuit is overloaded with other appliances, this appliance may not operate properly.
15. Store the rice cooker in a cool, dry place.
16. Avoid sudden temperature changes when using the rice cooker.
17. Use only with 120V AC power outlet.
18. Always make sure the outside of the inner cooking pot is dry prior to use. If cooking pot is returned to cooker when wet, it will damage this product causing it to malfunction.
19. Use extreme caution when opening the lid during or after cooking. Hot steam will escape and could cause burns.
20. To disconnect, turn any control to "off", then remove plug from wall outlet.
21. To reduce the risk of electric shock, cook only in removable container.

SAVE THESE INSTRUCTIONS

SHORT CORD INSTRUCTIONS

1. A short power-supply cord is provided to reduce risk resulting from becoming entangled in or tripping over a longer cord.
2. Longer extension cords are available and may be used if care is exercised in their use.
3. If a longer extension cord is used:
 - a. The marked electrical rating of the extension cord should be at least as great as the electrical rating of the appliance.
 - b. The longer cord should be arranged so that it will not drape over the counter top or tabletop where it can be pulled by children or tripped over unintentionally.

POLARIZED PLUG

This appliance has a **polarized plug** (one blade is wider than the other); please follow the instructions below:

To reduce the risk of electric shock, this plug is intended to fit into a polarized outlet only one way. If the plug does not fit fully into the outlet, reverse the plug. If it still does not fit, contact a qualified electrician. Do not attempt to modify the plug in any way.



ADDITIONAL IMPORTANT SAFETY INFORMATION

- Always place the rice cooker on a flat and heat-resistant surface, and use it in a well-ventilated area.
- The heating base and the other parts may become very hot. Be sure to use the handles and wear protective oven mitts or gloves.

This appliance is for household use only.

PARTS IDENTIFICATION

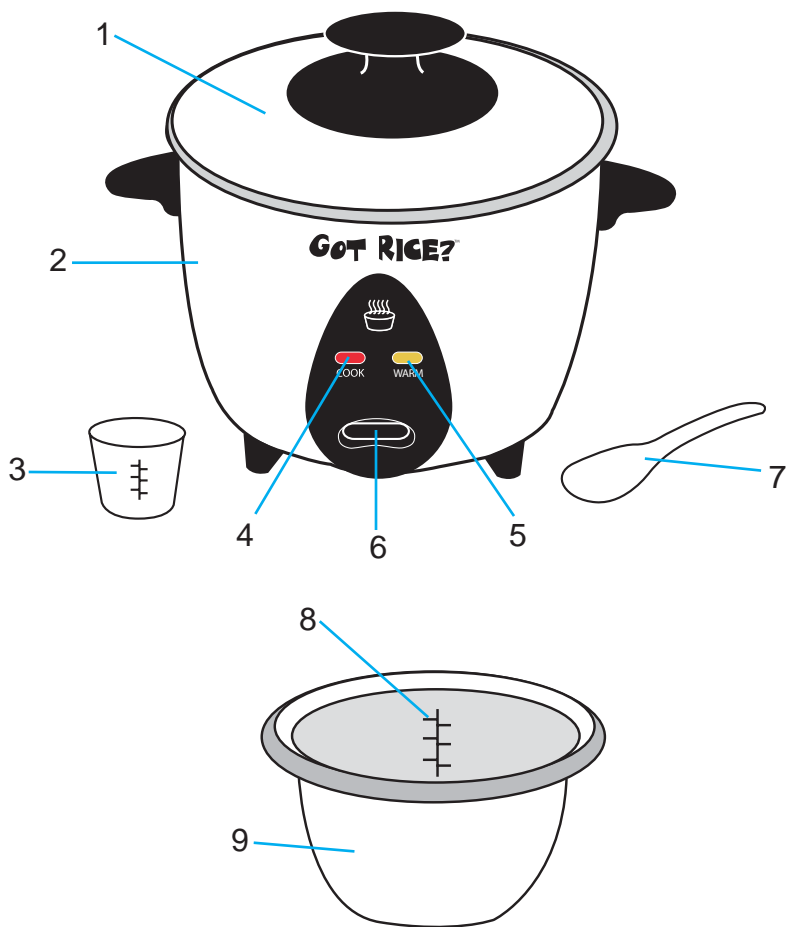

1. Glass Lid
2. Rice Cooker Body
3. Measuring Cup
4. Cook Indicator Light
5. Warm Indicator Light
6. Power Switch
7. Rice Paddle
8. Water Measurement Line
9. Inner Pot

HOW TO USE

Before Your First Use:

1. Read all instructions and important safeguards before using this appliance.
2. Remove all packaging materials and make sure the rice cooker and the accessories are received in good condition.
3. Tear up all plastic bags as they can pose a risk to children.
4. Wash all accessories in warm soapy water. Rinse and dry thoroughly.
5. Remove the inner pot from the rice cooker and clean with warm soapy water. Rinse and dry thoroughly before returning to the cooker.
6. Wipe the body of the rice cooker clean with a damp cloth.

- **Do not use abrasive cleaners or scouring pads to clean this appliance.**
- **Do not immerse the rice cooker base, cord or plug in water at any time.**

To Cook Rice:

1. Using the measuring cup provided, measure and add rice to the pot. One full level cup equals one cup.
2. Rinse the rice in a separate container with water until the water becomes relatively clear.
3. Place the rice into the inner pot. Using the water measurement lines in the inner pot or the provided measuring cup, add the appropriate amount of water to the inner pot. A rice/water measurement chart has been included on page 6.
4. To make softer rice, allow the rice to soak for 10-20 minutes before cooking.
5. Place the lid back on the rice cooker and plug the power cord into the electric outlet.
6. To start cooking, press the power switch down. The cook indicator light will then illuminate. Once cooking has completed, the rice cooker will automatically switch to keep warm mode and the warm indicator light will illuminate.
7. After the rice cooker has switched to warm mode, let the rice stand for 5-10 minutes in the inner pot without removing the lid. This ensures that the rice will be thoroughly cooked.
8. When you are finished cooking with the rice cooker, unplug it from the electrical outlet and allow it to cool.

CAUTION:

- Do not remove the lid during cooking. Hot steam will escape and may cause burns.
- If the outside of the inner pot is wet when it is returned to cooker, it may damage this product and cause it to malfunction.

HOW TO CLEAN

Always unplug unit and allow to cool completely before cleaning

1. Remove the inner cooking pot and lid from the rice cooker. Use a nylon sponge or dishcloth and wash the inner pot, lid, and other accessories in warm, soapy water.
 2. Rinse and dry thoroughly.
 3. Wipe the body of the rice cooker clean with a damp cloth.
- Do not use abrasive cleaners or products that are not considered safe to use on non-stick coatings.
 - This appliance and its inner pot are NOT dishwasher safe.
 - Always make sure the outside of the inner pot is dry prior to next use. If the inner pot is wet, it may damage this product and cause it to malfunction.

COOKING GUIDES

Rice/Water Measurement Chart:

UNCOOKED RICE	WATER WITH MEASURING CUP	WATERLINE INSIDE POT	APPROX COOKED RICE YIELD
1 Cup	1-1/2 Cups	Line 1	2 Cups
2 Cups	2-1/2 Cups	Line 2	4 Cups
3 Cups	3-1/2 Cups	Line 3	6 Cups

NOTE

- When cooking brown or wild rice, add an additional 3/4 cup of water.
- The measuring cup included is not a standard cup. The chart above refers to cups of rice and water based on the measuring cup provided with your rice cooker. Do not use more than 3 measuring cups of uncooked rice based on the measuring cup provided with this rice cooker.

HELPFUL HINTS:

1. Rinse the rice thoroughly to remove excess bran and starch. This will help reduce browning and sticking of the rice to the bottom of the pot.
2. If you have experienced any sticking due to the type of rice you are using, try adding a light coating of vegetable oil or cooking spray to the bottom of the inner pot before adding rice.
3. The above chart is only meant to serve as a general measuring guide. As there are many varieties of rice available (see *About Rice* on page 7), rice and water measurement may vary slightly.

ABOUT RICE

Rice is a valuable source of low fat, complex carbohydrates and is abundant in thiamin, niacin and iron. It is an essential ingredient for a healthy diet.

There are many different varieties of rice available in the market. Your Aroma Rice Cooker can cook any type of rice perfectly every time. Following are the commonly available varieties of rice and some of their characteristics:

Long Grain Rice

Typically this rice is not starchy and has loose, individual grains after cooking.

"California" rice is soft; "Carolina" is a little firmer, and "Jasmine" is the firmest of the long grain variety and is also flavorful and aromatic.

Short Grain Rice

Short grain is characteristically soft, sticky and chewy. This is the type of rice used to make sushi. "California" rice is soft; "Sweet Rice", often called "pearl" rice for its round shape, is extra sticky and is also excellent for making rice pudding.

Brown Rice

Brown rice is often considered the most healthy variety of rice. It has bran layers on the rice grains and contains more B-complex vitamins, iron, calcium, and fiber than polished (white) rice. The most popular brown rice is long grain, which has a chewy texture.

Wild Rice

Wild Rice comes in many delicious varieties and mixes. Often it is mixed with long grain rice for its firmer texture and is rich brown to black in color. Wild rice makes wonderful stuffing for poultry when cooked with broth and mixed with your favorite dried nuts and fruits.

LIMITED WARRANTY

Aroma Housewares Company warrants this product free from defects in material and workmanship for one year from provable date of purchase in the continental United States.

Within this warranty period, Aroma Housewares Company will repair or replace, at its option, defective parts at no charge, provided that the product is returned, freight prepaid with proof of purchase and U.S. \$6.00 for shipping and handling charges payable to Aroma Housewares Company. Before returning an item, please call the toll free number below for the return authorization number. Allow 2-4 weeks for return shipping.

This warranty does not cover improper installation, misuse, abuse or neglect on the part of the owner. Warranty is also invalid in the case that the product is taken apart or serviced by an unauthorized service station.

This warranty gives you specific legal rights which may vary from state to state and does not cover areas outside the United States.

AROMA HOUSEWARES COMPANY

6469 Flanders Drive

San Diego, California 92121

1-800-276-6286

M-F, 8:30 AM - 5:00 PM, Pacific Time

Website: www.aromaco.com